

Low Pressure • Medium Pressure • High Pressure • Accessories • Off-line Filtration

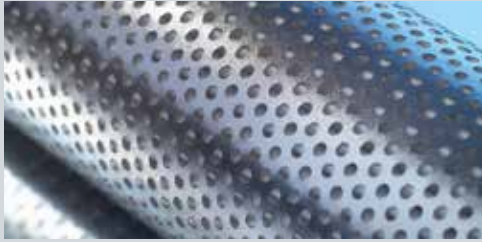

The best solution for clean, dry oil.

Clean dry oil is essential for your equipment. Donaldson Company, a leader in filtration for over 90 years, has proven performance in thousands of applications. Now offering a complete range of contamination control solutions.

This catalogue contains our most popular hydraulic filter range and accessories. The flow rates shown are the maximum for that assembly and will be influenced by, without being limited to, pressure, temperature, contamination, fluid type and viscosity.

Please contact Donaldson for assistance with filter specification.

To replace an existing filter cartridge or element, please use our cross reference system www.donaldsontoolbox.com.au

Low Pressure Filters..... 3

SP 15/25.....3
 SP50/60 and SP80/90.....4
 FIK In-Tank Filter.....5
 Service Indicators.....5

Medium Pressure Filters..... 6

HMK03.....6
 HMK04/24.....7
 HMK05/25.....8
 Service Indicators.....8

High Pressure Filters..... 9

FPK02.....9
 HPK03.....10
 HPK04.....10
 HPK05.....11
 Service Indicators.....11

Accessories..... 12

Fluid Level Temperature Gauges.....12
 Sight Glasses.....12
 T.R.A.P. Breathers.....13
 Clean and Dry Diesel Kit.....13

Off-Line Filtration..... 14

B.O.S.S. Bulk Oil Service System.....14
 Bu.F.S.S. Bulk Fuel Service System.....14
 Bu.F.S.S. 12V Bulk Fuel Service System.....14

Clean Fuel and Lubrication Solutions..... 15

Clean Fuel and Lubrication Solutions.....15
 Bulk hP.....15

Low Pressure Filter Assemblies

Low pressure filters are the most common type of filter in hydraulic circuits. They are often used as return line filters in applications with working pressures up to 150 psi, depending on model selected.

Hydraulic Series	Flow Range	Working Pressure	Porting Types	Media
SP15/25	0-114 l/min	150 psi 1034 kPa 10.3 bar	3/4" NPT	Cellulose Synteq Wiremesh Water absorbing
SP50/60	0-227 l/min	150 psi 1034 kPa 10.3 bar	SAE-20 O-Ring 1 1/4" NPT	Cellulose Synteq Wiremesh Water absorbing
SP80/90 Dual Head Dual Elements	0-380 l/min	150 psi 1034 kPa 10.3 bar	1 1/2" NPT, 2" SAE 4-Bolt Flange	Cellulose Synteq Wiremesh Water absorbing
FIK	0-639 l/min	147 psi 1000 kPa 10 bar	SAE-12 O-Ring SAE-16 O-Ring SAE- 20 O-Ring SAE- 24 O-Ring 2" SAE 4 Bolt Flange	Cellulose Synteq

0 - 114 l/min - SP15/25 Head

Port Size	Bypass Range	Gauge Ports	Gauge Port Location	Part No.
3/4" NPT	25 psi / 172.5 kPa / 1.72 bar	1/8" NPT	Upstream side	P561131

SP15/25 Elements

Media Type	$\beta_{x(c)} = 200$ Rating	$\beta_{x(c)} = 1000$ Rating	Length		Part No.	Seal Material
			in	mm		
Synteq Media		6	5.35	136	P564967	BunaN
Synteq Media		10	5.35	136	P560693	BunaN
Cellulose		23	5.35	136	P551551	BunaN
Cellulose		23	7.87	200	P565059	BunaN
Cellulose	32		5.35	136	P551553	BunaN
Wiremesh	150		5.68	144	P550274	BunaN
Water Absorbing Media	32		5.35	136	P565062	BunaN



Filters Shown with P561131 Head

0-227 l/min - SP50/60 Heads (Single)

Port Size	Bypass Range	Gauge Ports	Gauge Port Location	Part No.
1 1/4" NPT	25 psi / 172.5 kPa / 1.72 bar	(2) 1/8" NPT	Upstream side	P563268
SAE-20 O-Ring	25 psi / 172.5 kPa / 1.72 bar	(2) 1/8" NPT	Upstream side	P563272
SAE-20 O-Ring	No Bypass	(2) 1/8" NPT	Upstream side	P564147

0-380 l/min - SP80/90 Head (Dual)

Port Size	Bypass Range	Gauge Ports	Gauge Port Location	Part No.
1 1/2" NPT & 2" SAE 4 Bolt	25 psi / 172.5 kPa / 1.72 bar	(4) 1/8" NPT	Upstream & Down stream sides	P563274



SP50/60 and SP80/90 Elements

Media Type	$\beta_{x(c)} = 200$ Rating	$\beta_{x(c)} = 1000$ Rating	Length		Part No.	Seal Material
			in	mm		
Synteq		6 μ m	6.7	170	P169430	BunaN
			10.7	271	P167832	BunaN
Synteq		9 μ m	6.7	170	P167162	BunaN
			10.7	271	P165762	BunaN
Synteq		10 μ m	6.7	170	P165875	BunaN
			10.7	271	P165876	BunaN
Synteq		23 μ m	6.7	170	P165877	BunaN
			10.7	271	P165878	BunaN
Synteq		>50 μ m	6.7	170	P165879	BunaN
			10.7	271	P165880	BunaN
Cellulose		24 μ m	6.7	170	P550386	BunaN
			6.7	170	P550388	BunaN
Cellulose		23 μ m	7.0	179	P550148	BunaN
			10.7	271	P550251	BunaN
Cellulose	32 μ m		6.7	170	P550387	BunaN
Water Absorbing	10 μ m		10.7	271	P561183	BunaN
Wiremesh	150 μ m nominal		6.7	170	P550275	BunaN
			10.7	271	P550276	BunaN



Filters Shown with P563268 Head

FIK In-Tank Assemblies and Replacement Elements

The FIK in-tank return line filters are economical and space saving with simple screw-on covers, ideal for low pressure, in-tank applications. This is a heavy duty filter, with die-cast aluminium head and steel canister. The head (and inlet) sit above the tank, with the housing (and outlet) in the tank.

0-639 l/min - FIK Housings

Port Size	Bypass Rating	FIK Assembly Number	$\beta_{x(c)} = 1000$ Rating	Filter Media	Provided with this Element	Flow Range
SAE-12 O-Ring	22 psi / 150 kPa / 1.5 bar	K040811	36	Cellulose	P171527	53 l/min
SAE-16 O-Ring	22 psi / 150 kPa / 1.5 bar	K040812*	36	Cellulose	P171533	86 l/min
SAE-20 O-Ring	22 psi / 150 kPa / 1.5 bar	K051204*	36	Cellulose	P171539	177 l/min
SAE-24 O-Ring	22 psi / 150 kPa / 1.5 bar	K070248*	36	Cellulose	P171557	248 l/min
2" SAE 4-Bolt Flange	22 psi / 150 kPa / 1.5 bar	K070250*	36	Cellulose	P171581	639 l/min

*Models have service indicator port available

Note: Bypass valve is integral part of replacement filter

FIK Elements

Media Type	$\beta_{x(c)} = 1000$ Rating	K040811	K040812	K051204	K070248	K070250
Synthetic	11	P171525	P171531	P171537	P171555	P171579
Cellulose	23		P171532			P171580
Cellulose	36	P171527	P171533		P171557	P171581
Cellulose	40		P171534	P171540		P171582
Wire Mesh	60 μ m		P171535			P171583



Service Indicators

Part No.	Pressure Rating	Description	Where Used
P563978	30 psi / 200 kPa / 2.07 bar	Electrical indicator Adjustable 5-30 psi	SP15/25 SP50/60 SP80/90
P171966	22 psi / 150 kPa / 1.5 bar	AC/DC 0.5A resistive 0.2A inductive	FIK
P563298	Return function Range: 0 to 100 psi Colour coded (25 psi)	Pressure Gauge	SP15/25 SP50/60 SP80/90
P171958	17 psi / 117 kPa / 1.17 bar	Visual Indicator	FIK

P563978

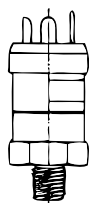

P171966



P563298



P171958



Medium Pressure Filter Assemblies

The HMK series of spin-on hydraulic filters feature high performance, high flow and medium pressure. They are designed for return line and side loop systems. Applications include fluid conditioning, process systems, lube oil systems, power transmission, case drains, hydrostatic charge pumps and cooling systems. The element has a heavy-duty steel body with die-cast top plate and the head is made from die-cast aluminium.

Hydraulic Series	Flow Range	Working Pressure	Porting Types	Media
HMK03	0-95 l/min	1000 psi 6895 kPa 69 bar	SAE-12 O-Ring	Synteq Cellulose
HMK04	0-130 l/min	500 psi 3447 kPa 34.05 bar	SAE-12 O-Ring SAE-16 O-Ring ¾" NPT, 1" NPT	Synteq Water Removal
HMK24 Dual Head Dual Elements	0-230 l/min	500 psi 3447 kPa 34.5 bar	SAE-20 O-Ring 1¼" SAE 4-Bolt Flange	Synteq Water Removal
HMK05	0-189 l/min	350 psi 2413 kPa 24.1 bar	SAE-20 O-Ring 1 ¼" NPT	Synteq Wiremesh Water Removal
HMK25 Dual Head Dual Elements	0-378 l/min	350 psi 2413 kPa 24.1 bar	1½" SAE4-Bolt Flange	Synteq Wiremesh Water Removal

* Up to

0-95 l/min - HMK03 Heads (Single)

Port Size	Bypass Rating	Indicator Visual	Indicator Options	Part No.
SAE-12 O-Ring	50 psi / 345 kPa / 3.45 bar	None	C	P170773
SAE-12 O-Ring	50 psi / 345 kPa / 3.45 bar	D	C	P179460
SAE-12 O-Ring	No Bypass	None	C	P170327

HMK03 Elements

Media Type	β _{x(c)} = 1000 Rating	Length		Part No.	Seal Material
		in	mm		
Synteq	6 µm	5.5	140	P170306	BunaN
		9.5	242	P170307	BunaN
Synteq	9 µm	5.5	140	P170308	BunaN
		9.5	242	P170309	BunaN
Synteq	10 µm	9.5	242	P176107	BunaN
Synteq	14 µm	9.5	242	P173702	BunaN
Synteq	20 µm	5.5	140	P170310	BunaN
		9.5	242	P170311	BunaN
Synteq	23 µm	5.5	140	P170312	BunaN
		9.5	242	P170313	BunaN
Cellulose	29 µm	5.5	140	P170480	BunaN
		9.5	242	P170089	BunaN



Filter Shown with P179460 Head

0-130 l/min - HMK04 Heads (Single)

Port Size	Bypass Rating	Indicator Visual	Indicator Options	Part No.
3/4" NPT	25 psi / 172 kPa / 1.72 bar	D - Left	None	P169310
SAE-12 O-Ring	No Bypass	D - Left	None	P169320
1" NPT	25 psi / 172 kPa / 1.72 bar	D - Both	A, C	P166086
SAE-16 O-Ring	25 psi / 172 kPa / 1.72 bar	D - Left	None	P166417
		D - Both	A, C	P166088
		No Bypass	D - Both	A, C

0-230 l/min - HMK24 Heads (Dual)

Port Size	Bypass Rating	Indicator Visual	Indicator Options	Part No.
SAE-20 O-Ring	No Bypass	None	A, C	P179609
1 1/4" SAE 4-Bolt Flange	50 psi / 345 kPa / 3.45 bar	None	A, C	P179582

HMK04 and HMK24 Elements

Media Type	$\beta_{x(c)} = 1000$ Rating	Length		Part No.	Seal Material
		in	mm		
Synteq	< 4 μ m	9.4	240	P165185	Viton
Synteq	6 μ m	9.4	240	P167590	BunaN
		6.0	152	P165354	BunaN
		9.4	240	P165332	BunaN
Synteq	9 μ m	11.6	295	P179343	BunaN
		9.4	240	P170950	BunaN
Synteq high collapse	9 μ m	9.4	240	P170950	BunaN
Synteq	10 μ m	6.0	152	P176565	BunaN
		9.4	240	P176566	BunaN
Synteq	20 μ m	6.0	152	P164375	BunaN
		9.4	240	P164378	BunaN
Synteq	33 μ m	6.0	152	P164381	BunaN
		9.4	240	P164384	BunaN
Synteq	> 50 μ m	6.0	152	P165335	BunaN
		9.4	240	P165338	BunaN
Water Removal	NA	9.4	240	P560584	BunaN

Standard collapse 150 psi / 1034 kPa / 10.3 Bar

High collapse 300 psi / 2068 kPa / 20.7 bar



Filter Shown with P166086 Head



Filters Shown with P179582 Head

0-189 l/min - HMK 05 Heads (Single)

Port Size	Bypass Rating	Indicator Visual	Indicator Options	Part No.
1 ¼" NPT	25 psi / 172 kPa / 1.72 bar	D - Both	A, C	P167294
	25 psi / 172 kPa / 1.72 bar	D - Both	A, C	P165973
SAE-20 O-Ring	50 psi / 345 kPa / 3.45 bar	D - Left	A, C	P561885
	No Bypass	D - Both	A, C	P166663

0-378 l/min - HMK 25 Head (Dual)

Port Size	Bypass Rating	Indicator Visual	Indicator Options	Part No.
1 ½" SAE 4-Bolt Flange	25 psi / 172.5 kPa / 1.72 bar	D - Both	A, C	P167296

HMK05 and HMK25 Elements

Media Type	βx(c) = 1000 Rating	Length		Part No.	Seal Material
		in	mm		
Synteq	< 4 μm	14.2	361	P564468	BunaN
Synteq	6 μm	11.6	294	P170906	BunaN
		11.6	294	P165675	BunaN
Synteq	9 μm	14.2	361	P179763	BunaN
		11.6	294	P176567	BunaN
Synteq	10 μm	11.6	294	P176567	BunaN
		14.2	361	P170949	BunaN
Synteq	14 μm	14.2	361	P170949	BunaN
		11.6	294	P165659	BunaN
Synteq	20 μm	11.6	294	P171275	Viton
		11.6	294	P165569	BunaN
Synteq	23 μm	11.6	294	P165569	BunaN
Synteq	> 50 μm	11.6	294	P165672	BunaN
Wiremesh	150 μm @ β200	11.6	294	P173943	BunaN
Water Removal	na	11.6	294	P179075	BunaN

Filter Notes

Filter with seals made of BunaN are appropriate for most applications involving petroleum oil. Filters with seals made of Viton® (a fluoroelastomer) are required when using diester, phosphate ester fluids, water glycol, water/oil emulsions, and HWCF (high water content fluids) over 65°C. Donaldson offers both types, as shown in the tables above. (Viton® is a registered trademark of DuPont Dow Elastomers). Filters with seals made of BunaN are appropriate for most applications involving petroleum oil.

Service Indicators

Part No.	Pressure Rating	Description	Where Used	Style
P173944	25 psi / 172.5 kPa / 1.72 bar	AC/DC 3-wire White: normally open Red: normally closed Black: common	HMK03, HMK04/24 HMK05/25, Bulk hP	C
P174396	50 psi / 345 kPa / 3.45 bar	AC/DC 3-wire White: normally open Red: normally closed Black: common	HMK03, HMK04/24 HMK05/25, Bulk hP	C
P162400	25 psi / 172.5 kPa / 1.72 bar	DC/Single post Normally open	HMK04/24, HMK05/25 Bulk hP	A
P165965	50 psi / 345 kPa / 3.45 bar	Visual Indicator	HMK03, Bulk hP	D
P162696	25 psi / 172.5 kPa / 1.72 bar	Visual Indicator	HMK04/24, HMK05/25	D
P167580	50 psi / 345 kPa / 3.45 bar	Visual Indicator	HMK04/24, HMK05/25	D



P173944
P174396



P162400

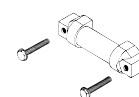

P165965
P162696
P167580

High Pressure Hydraulic Assemblies

The following are high pressure hydraulic assemblies used on in-plant and mobile hydraulic systems. Applications include hydrostatic transmissions and high pressure circuit systems. Made from ductile iron for strength and durability, they are available with a reverse flow check valve which allows bi-directional flow through the filter head.

Hydraulic Series	Flow Range Return	Working Pressure	Porting Types	Media
FPK02	0-95 l/min	6090 psi 42000 kPa 420 bar	SAE-12 O-Ring	Synteq
HPK03	0-227 l/min	3000 psi 20685 kPa 206.9 bar	SAE-16 O-Ring	Synteq DX2
HPK04	0-454 l/min	6000 psi 41369 kPa 413.7 bar	1 ¼" SAE 4 Bolt Flange 1 ½" SAE 4 Bolt Flange	Synteq DX2
HPK05	0-757 l/min	3000 psi 20685 kPa 206.9 bar	2" SAE 4-Bolt Flange	Synteq

0-95 l/min - FPK02 - Head

Port Size	Bypass Rating	Indicator Options	Part No.
SAE 12 O-Ring	87 psi / 600 kPa / 6 bar	E, F	P762766

FPK02 - Housings

Length		Part No
in	mm	
4	102	P762769
8	203	P762770

Note: Head assemblies include head-to-housing seal.

FPK02 - Elements

Media Type	$\beta_{x(c)} = 1000$ Rating	Length		Part No.	Seal Material
		in	mm		
Synteq	6 μ m	4.37	111	P167180 High Collapse	Flurocarbon
		8.12	203	P167838 P167182 High Collapse	BunaN Flurocarbon
Synteq	9 μ m	4.37	111	P165041	BunaN
		8.12	203	P165043 P165006	BunaN BunaN
Synteq	10 μ m	4.37	111	P167181 High Collapse	Flurocarbon
		8.12	203	P165015 P167183 High Collapse	BunaN Flurocarbon
Synteq	23 μ m	4.37	111	P165136	BunaN
		8.12	203	P165138	BunaN

Standard collapse 150 psi / 1034 kPa / 10.3 Bar

High collapse 300 psi / 2068 kPa / 20.7 bar



Filter Shown with P762766 Head with 8" housing

0-227 l/min - HPK03 Head

Port Size	Bypass Rating	Indicator Visual	Indicator Options	Part No.
SAE-16 O-Ring	50 psi / 345 kPa / 3.45 bar	D - Left	G, H	P166353

HPK03 - Housing

Length	Part No.	
	in	mm
8	209	P179579

Note: Head assemblies include head-to-housing seal.

0-454 l/min - HPK04 Heads

Port Size	Bypass Rating	Indicator Visual	Indicator Options	Part No.
1 1/2" SAE 4 Bolt Flange (code 62)	50 psi / 345 kPa / 3.45 bar	D - Left	G, H	P567642
1 1/4" SAE 4 Bolt Flange (code 62)	90 psi / 620 kPa / 6.2 bar Reverse flow check valve	D - Left	G, H	P567644

HPK04 - Housings

Length	Part No.	
	in	mm
8	203	P567650
13	330	P567649
16	406	P567648

Note: Head assemblies include head-to-housing seal.

HPK03 & HPK04 Elements

Media Type	$\beta_{x(c)} = 1000$ Rating	Length		Part No.	Seal Material	Suits
		in	mm			
DX2	5 μ m	8	208	P565122	Viton	HPK03, HPK04
		13	328	P565188	Viton	HPK04
		16	427	P565196	Viton	HPK04
Synteq	6 μ m	8	208	P167842	BunaN	HPK03, HPK04
				P167185 High Collapse	Viton	HPK03, HPK04
		13	328	P169432	BunaN	HPK04
		16	427	P169433	BunaN	HPK04
				P167187 High Collapse	Viton	HPK04
DX2	8 μ m	8	208	P565123	Viton	HPK03, HPK04
		13	328	P565189	Viton	HPK03
		16	427	P565197	Viton	HPK03
Synteq	9 μ m	8	208	P164594	BunaN	HPK03, HPK04
		13	328	P164596	BunaN	HPK04
		16	427	P164598	BunaN	HPK04
Synteq	10 μ m	8	208	P164166	BunaN	HPK03, HPK04
				P167186 High Collapse	Viton	HPK03, HPK04
		13	328	P164168	BunaN	HPK04
		16	427	P164170	BunaN	HPK04
DX2	14 μ m	8	208	P564936	Viton	HPK03, HPK04
		13	328	P565187	Viton	HPK04
		16	427	P565195	Viton	HPK04
Synteq	23 μ m	8	208	P164174	BunaN	HPK03, HPK04
		13	328	P164176	BunaN	HPK04
		16	427	P164178	BunaN	HPK04



Filter Shown with P166353 with 8" housing



Filter Shown with P567642 with 16" housing



Standard collapse 150 psi / 1034 kPa / 10.3 Bar

High collapse 300 psi / 2068 kPa / 20.7 bar

0-757 l/min - HPK05 Assembly

Port Size	Bypass Rating	Assembly Number	Bx(c) = 1000 Rating	Provided with this element
2" SAE 4 Bolt Flange (Code61)	60 psi / 414 kPa / 4.14 bar Reverse flow check valve	K052024	23	P164229

HPK05 Elements

Media Type	βx(c) = 1000 Rating	Length		Part No.	Seal Material
		in	mm		
DT	5 μm	25.5	648	P566450	Viton
Synteq	9 μm	25.5	648	P164585	BunaN
Synteq	10 μm	25.5	648	P164227	BunaN
Synteq	23 μm	25.5	648	P164229	BunaN



Service Indicators

Part No.	Pressure Rating	Description	Style	Where Used
P171947	72 psi / 496 kPa / 4.96 bar	AC/DC normally open or closed 250 VAC or 30 VDC max 5A resistive/inductive Electrical/Visual Combination	F	FPK02
P569634	50 psi / 345 kPa / 3.45 bar	Hirschmann receptacle 115 VAC/28 VDC, 2 amps	G	HPK03 HPK04 HPK05
P567986	50 psi / 345 kPa / 3.45 bar	Thermal lockout & serge control, Hirschmann receptacle 115 VAC/28 VDC, 2 amps 4 pin DIN 43650	H	HPK03 HPK04 HPK05
P171945	72 psi / 496 kPa / 4.96 bar	Visual Indicator	E	FPK02 HPK03
P164315	50 psi / 345 kPa / 3.45 bar	Visual Indicator	D	HPK04 HPK05

P171947

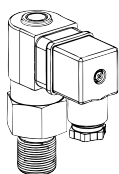

**P569634
P567986**

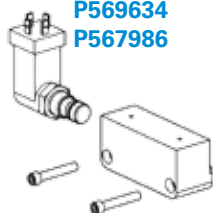

P171945

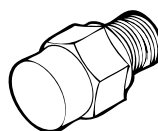

P164315

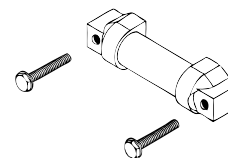

Fluid Level Temperature Gauges

Part No.	Dim. A (in./mm)	Dim. B (in./mm)	Dim. C (in./mm)	Dim. D (in./mm)	Dim. E (in./mm)	Dim. F (in./mm)	Dim. G	Dim. H (in./mm)	Dim. I (in./mm)
① P171913	4.21/107	1.22/31	.89/22.5	1.57/40	.61/15.5	3/76	M10 x 1.5	.78/20	1.57/40
P171920	6.22/158	3.22/82	.89/22.5	1.57/40	.61/15.5	5/127	M12 x 1.5	.78/20	1.57/40
P562448	6.34/161	2.91/74	.90/23	1.22/31	0.47/12	5.0/127	M12 x 1.5	.90/23	1.61/41
① P171921	11.2/285	8.23/209	.89/22.5	1.57/40	.61/15.5	10/254	M12 x 1.5	.78/20	1.57/40
P171922	11.22/285	8.23/209	.89/22.5	1.57/40	.61/15.5	10/254	M12 x 1.5	.78/20	1.57/40

① Level only ② Maximum working pressure 14.5 psi / 100 kPa / 1 bar ③ Max pressure 260PSI / 1792kPa / 17.92 bar

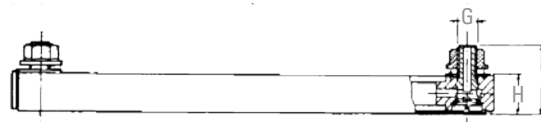
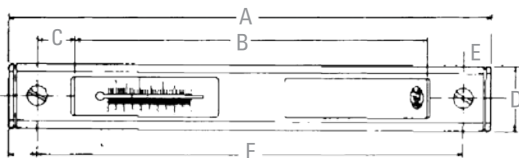

Sight Glasses

Leak-free sight glasses come in plastic or metal with a variety of threads, seals and lenses. In low visibility areas, prism lens sight glasses are a good solution for quick and accurate readings. In applications involving high pressure or temperatures, steel sight glasses are preferred. Locking nuts provide mounting into sheet metal with minimum thickness and without welding.

Sight Glasses

Description:

Transparent polyamid lens	For use with mineral, petroleum and water-based fluids
Shock resistant	Any contact with alcohol or solvents must be avoided
Anodized aluminum reflector	Design HFTX
Operating temperature 210°F / 100°C	Working pressure 29 psi / 200 kPa / 2 bar
BunaN seal	

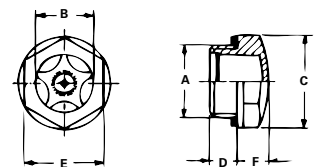

Part No.	Description	Thread Size Dim. A (in.)	Dim. B (in./mm)	Dim. C (in./mm)	Dim. D (in./mm)	Dim. E (in./mm)	Dim. F (in./mm)
P562419	SG-04	1/4" BSP	0.35/9	0.71/18	0.28/7	0.59/15	0.24/6
P562420	SG-06	3/8" BSP	0.43/11	0.87/22	0.32/8	0.75/19	0.28/7
P562421	SG-08	1/2" BSP	0.55/14	1.02/26	0.32/8	0.87/22	0.32/8
P562426	SG-12	3/4" BSP	0.79/20	1.22/31	0.35/9	1.06/27	0.39/10

Prism Sight Glasses

Description:

All nickel-plated steel construction	Reflects light in the presence of any liquid
Glass prism lenses hermetically sealed	Maximum operating temp. 500°F / 260°C
Leak-proof service	Suitable for petroleum and water-based fluids
Greater mechanical strength	Working pressure 500 psi / 3450 kPa / 34.5 bar
Easy installation	

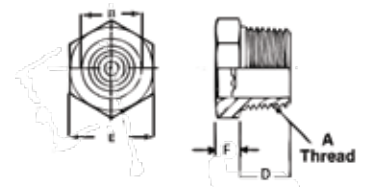

Part No.	Description	Thread Size Dim. A (in.)	Dim. B (in./mm)	Dim. D (in./mm)	Dim. E (in./mm)	Dim. F (in./mm)
P562412	SVM-16	1" NPT	0.94/24	0.94/24	1.38/35	0.31/8
P562414	SVM-24	1-1/2" NPT	1.44/37	0.81/21	2.00/51	0.41/11
P562415	SVM-32	2" NPT	1.88/48	0.88/22	2.50/64	0.41/11

T.R.A.P. Breather (Thermally Reactive Advanced Protection)

TRAP Breathers reduce dirt and air-borne moisture (humidity) from entering hydraulic and other fluid reservoirs. With models available for both stationary and mobile applications, they provide faster acting protection and greater capacity than silica gel breathers.

The dual protection TRAP has a self-regenerative outer media that reduces air-borne moisture down to 15% relative humidity, while the high capacity inner media is 97% efficient on particles down to 3um.

Part No.	Construction	Connection	Airflow	Diameter	Total Height
Mini					
P566174	Glass-filled nylon	9/16"-18UNF	85 L/min	41.9	55.4
P567390	Glass-filled nylon	3/8" NPT	85 L/min	41.9	55.4
P567392	Glass-filled nylon	1/4" NPT	85 L/min	41.9	55.4
Anti splash					
P766645	Glass-filled nylon	3/4" BSP	200 L/min	80.8	72.9
P766646	Glass-filled nylon	1" BSP	200 L/min	80.8	72.9
Metal					
P565857	Epoxy-coated steel	3/4" NPT	708 L/min	80.8	72.9
P565858	Epoxy-coated steel	Bayonet	708 L/min	80.8	72.9
P566037	Epoxy-coated steel	3/4" BSP	708 L/min	80.8	72.9
Large					
P566151 ²	Glass-filled ABS	1" NPT	1274 L/min	114	115
P564669 ¹	Glass-filled ABS	1" NPT	1274 L/min	114	115
P565616 ¹	Glass-filled ABS	Bayonet	1274 L/min	114	115
P505964 - Adapter	Steel	1" NPT Female - 3/4" BSP Male			
X-Large					
		For stationary applications only	Recommended / Max		
P923075 (Filter only)	Urethane	1 1/4" BSP	500 / 1893 L/min	165	220
DFF0078 (Assembly) ³	Brass, Urethane	1 1/2" NPT (Female)	500 / 1893 L/min	230	350



¹ Electronic indicator triggered by pressure differential, and flashes red to indicate a change out is required (1 PSID).

² Optional visual indicator

³ Includes visual indicator

Clean and Dry Diesel Filter Kit

Ideal for all diesel fuel applications up to 189 lpm

Modern diesel engines are being built to increasingly stringent specifications with finer operating tolerances. They require clean, dry fuel for optimum combustion, maximum power and the lowest emission levels. Dirt and water are the enemies of High Pressure Common Rail fuel systems and can dramatically reduce the service life of fuel system components.

This kit uses two high performance filters, in series, to clean your diesel fuel ready for use.

The first filter removes particulate contamination from diesel. Rated at <4um@b2000 (99.95% single pass), it is designed to target a cleanliness of ISO 14/13/11 in a single pass. The second filter uses a super absorbent polymer (SAP) that will not allow free water to pass. This combination of filters will ensure that your diesel is both clean and dry, for maximum performance.

For complete protection, Donaldson recommends installing a TRAP breather to keep air-borne contamination and moisture from entering your tank.



Part No.	Maximum Working Pressure	Flow Rate	Connection
P506073	350 psi / 246 kPa / 24.13 Bar	189 lpm	1 1/4" NPT

Bulk Service Systems

Donaldson provides off-line filtration and fluid transfer capabilities in convenient portable packages.

Use them in your workshop, with in-plant machinery, or mobile equipment to achieve and maintain the ISO cleanliness standards of your fluids.

B.O.S.S. - Bulk Oil Service System

Part Number	Specifications	Dimensions	Weight
P506037	Pump-Gear Pump (not suited for fuel transfer) Flow Rate: 40 lpm @ 1450 RPM Power Source: 240 Volt 50 Hz with 2m cable	H = 1300 mm W = 550 mm D = 700 mm	65 Kgs

Filters Supplied with Unit

Part Number	ISO Filter Efficiency	Quantity Required
P568664	25µm @ Beta 2000 (Engine Oil and Gear Oil)	2

Filters (Sold Separately)

P568665	7µm @ Beta 2000 (Transmission Oil and Hydraulic Oil)	2
P570248	Water Adsorbing Media (for Ethanol-Free Fluids)*	2



NOT FOR USE WITH DIESEL

Bu.FS.S. - Bulk Fuel Service System

Part Number	Specifications	Dimensions	Weight
P506057	Pump - Flow Rate: 63 lpm @ 2800 RPM Power Source: 240 Volt 50 Hz with 2m cable	H = 1300 mm W = 550 mm D = 700 mm	65 Kgs

Filters Supplied with Unit

Part Number	ISO Filter Efficiency	Quantity Required
P568666	<4µm @ Beta 2000 (Diesel Fuel)	2 (first dual head)
P570248	Water Adsorbing Media (for Ethanol-Free Fluids)*	2 (second dual head)



ONLY FOR USE WITH DIESEL

Bu.FS.S. 12V - Bulk Fuel Service System 12 Volt

Part Number	Specifications	Dimensions	Weight
X011408	Pump - Flow Rate: 57 lpm @ 2900 RPM Power Source: 12 Volt 35 Amp max	H = 576 mm W = 521 mm D = 186 mm	34 Kgs

Filters Supplied with Unit

Part Number	ISO Filter Efficiency	Quantity Required
P568666	<4µm @ Beta 2000 (Diesel Fuel)	1 (first dual head)
P570248	Water Adsorbing Media (for Ethanol-Free Fluids)*	1 (second dual head)



ONLY FOR USE WITH DIESEL * Constructed with super absorbent media that prevents water from entering storage equipment tanks. Not intended for particle removal

Clean Fuel and Lubrication Solutions Filter Assemblies

Series Indicator	Flow Range	Working Pressure	Indicator
CFLS Heads	0 - 473 lpm	350 psi / 2413 kPa / 24.1 Bar	Optional visual or electrical
CFLS Manifolds	0 - 2650 lpm	152 psi / 1050 kPa / 10.5 bar	Visual / optional electrical
Bulk hP	0 - 189 lpm	1000 psi / 6895 kPa / 69 bar*	Visual / optional electrical

Clean Fuel and Lubrication Solutions Heads and Manifolds

Description	Filter Qty	Porting Type	Recommended Flow Range	Part Number
Single Head	1	SAE-20 O-Ring	246 lpm	P570329
Single Head	1	1 1/4" NPT O-Ring	246 lpm	P570330
Dual Head	2	1 1/2" SAE4 bolt code 61	473 lpm	P568583
2 Head Manifold	4	2" ANSI 150 Flange	946 lpm	P561880
4 Head Manifold	8	4" ANSI 150 Flange	1893 lpm	P568932
5 Head Manifold	10	4" ANSI 150 Flange	2271 lpm	P568933
Modular Manifold	up to 12	4" ANSI 150 Flange	2650 lpm	DFF1012

Clean Fuel and Lubrication Solutions Filters

Type	Application	Target ISO	Mircon	Part No
Oil	Engine, Gear	18/16/13	25µm@β2000	P568664
Oil	Hydraulic	16/14/13	7µm@β2000	P568665
Fuel	Diesel	14/13/11	<4µm@β2000	P568666
Water absorb	Ethanol free fluids		n/a	P570248

Clean Fuel and Lubrication Solutions Bulk hP Filter Heads

Description	Filter Qty	Porting Type	Recommended Flow Range	Part Number
Single head no bypass	1	SAE-16 O-Ring	189 lpm	P566023
Single head 50psi bypass	1	SAE-20 O-Ring	189 lpm	P566024

Clean Fuel and Lubrication Solutions Bulk hP Filters

Type	Application	Micron	Part Number
Oil	Gear, heavy	14µm@β2000	P565183
Oil	Engine, Transmission	8µm@β2000	P565185
Oil	Hydraulic, Light	4µm@β2000	P565184*

* 800 psi / 5515 kPa / 55 Bar





Global Presence with Local Touch

Donaldson has established a global distribution network to serve our customers locally as well as worldwide. We operate as a global company with a network for primary distribution locations that support a mature hub of regional distribution centers and warehouses.

Donaldson distribution centers are strategically located to quickly and accurately deliver filtration and exhaust products wherever replacement products are needed. We work with a network of transportation, third party logistics companies,

consolidators and cross-docking facilities to meet or exceed our customers' requirements.

All regions of the world benefit from our global umbrella of distribution centers. We focus our efforts on local support and the capabilities of our staff. We continue to make significant investments in facilities, systems, supply chain relationships and staffing to offer the best order fulfillment options available.

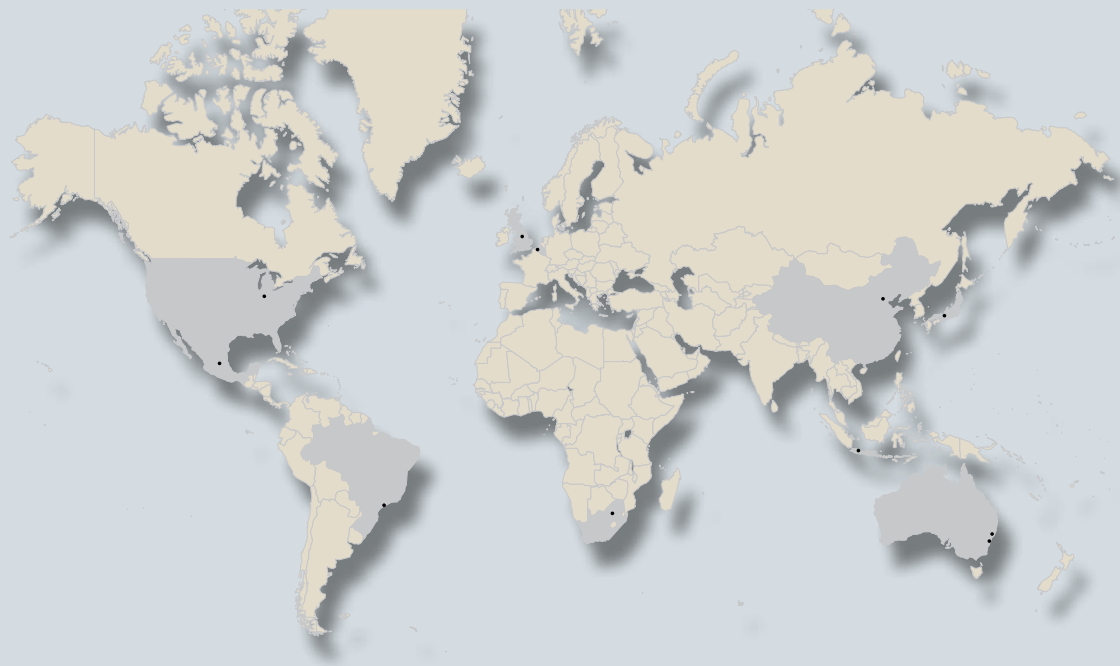

Donaldson Australasia Pty Ltd
PO Box 153, Wyong NSW 2259

Freecall: 1800 345 837
Ph: +61 2 4350 2000
Fax: +61 2 4351 2036

Donaldson New Zealand
PO Box 14-770, Panmure 1741 Auckland

Ph: +64 9 579 2790
Fax: +64 9 579 0322

Brochure No. 12IH006 (02/14)

© 2014 Printed in Australia. All rights reserved. Donaldson Company, Inc. reserves the right to change or discontinue any model or specification at any time and without notice.